

**Subject:** FW: JP07.320946 - Long Point 3D Visuals  
**Attachments:** Long Point 3D Visuals.pdf

---

**From:** Alice Sheridan <[asheridan@galwaycoco.ie](mailto:asheridan@galwaycoco.ie)>  
**Sent:** Thursday, November 21, 2024 9:00 AM  
**To:** Bord <[bord@pleanala.ie](mailto:bord@pleanala.ie)>  
**Subject:** JP07.320946 - Long Point 3D Visuals

**Caution:** This is an **External Email** and may have malicious content. Please take care when clicking links or opening attachments. When in doubt, contact the ICT Helpdesk.

Hello,  
I hope this email finds you well.

Can the attached file please be added to the supplementary information on reference JP07.320946 (Loughrea Long Point Amenity Enhancement Project - Part 10 Planning Application).

Many thanks,  
Alice

Alice Sheridan  
Urban and Rural Regeneration,  
Economic Development & Planning  
Galway County Council

Tel: 091 509 638 | Email: [asheridan@galwaycoco.ie](mailto:asheridan@galwaycoco.ie) | [www.galway.ie](http://www.galway.ie)

Is é Microsoft, Arna Óstáil do Comhairle Contae na Gaillimhe, a rinne an teachtaireacht ríomhphoist seo a scanadh agus a ghlanadh ó thaobh ábhair de. Tá míle fáilte roimh chomhfhreagras i nGaeilge nó i mBéarla. Tá eolas atá príobháideach agus rúnda sa ríomhphost seo agus in aon iatán a ghabhann leis agus is don seolaí amháin é. Mura seolaí thú, níl tú údaraithe an ríomhphost nó aon iatán a ghabhann leis a léamh, a chóipeáil ná a úsáid. Má tá an ríomhphost seo faighte agat trí dhearmad, cuir an seoltóir ar an eolas trí ríomhphost a sheoladh ar ais agus scríos ansin é le do thoil. Má tá an ríomhphost seo ag teastáil uait i bhformáid eile téigh i dteagmháil leis an duine a sheol chugat é. This e-mail message has been scanned for content and cleared by Microsoft Hosted for Galway County Council. Correspondence is welcome in Irish or in English. This e-mail and any attachment contains information which is private and confidential and is intended for the addressee only. If you are not an addressee, you are not authorised to read, copy or use the e-mail or any attachment. If you have received this e-mail in error, please notify the sender by return e-mail and then destroy it. If you need this email in an alternative format please contact the sender.

# Loughrea Long Point Amenity Enhancement Project - Part 10 Planning Application

ABP Reference JP07.320946



▲ 3d Render; Proposed Development

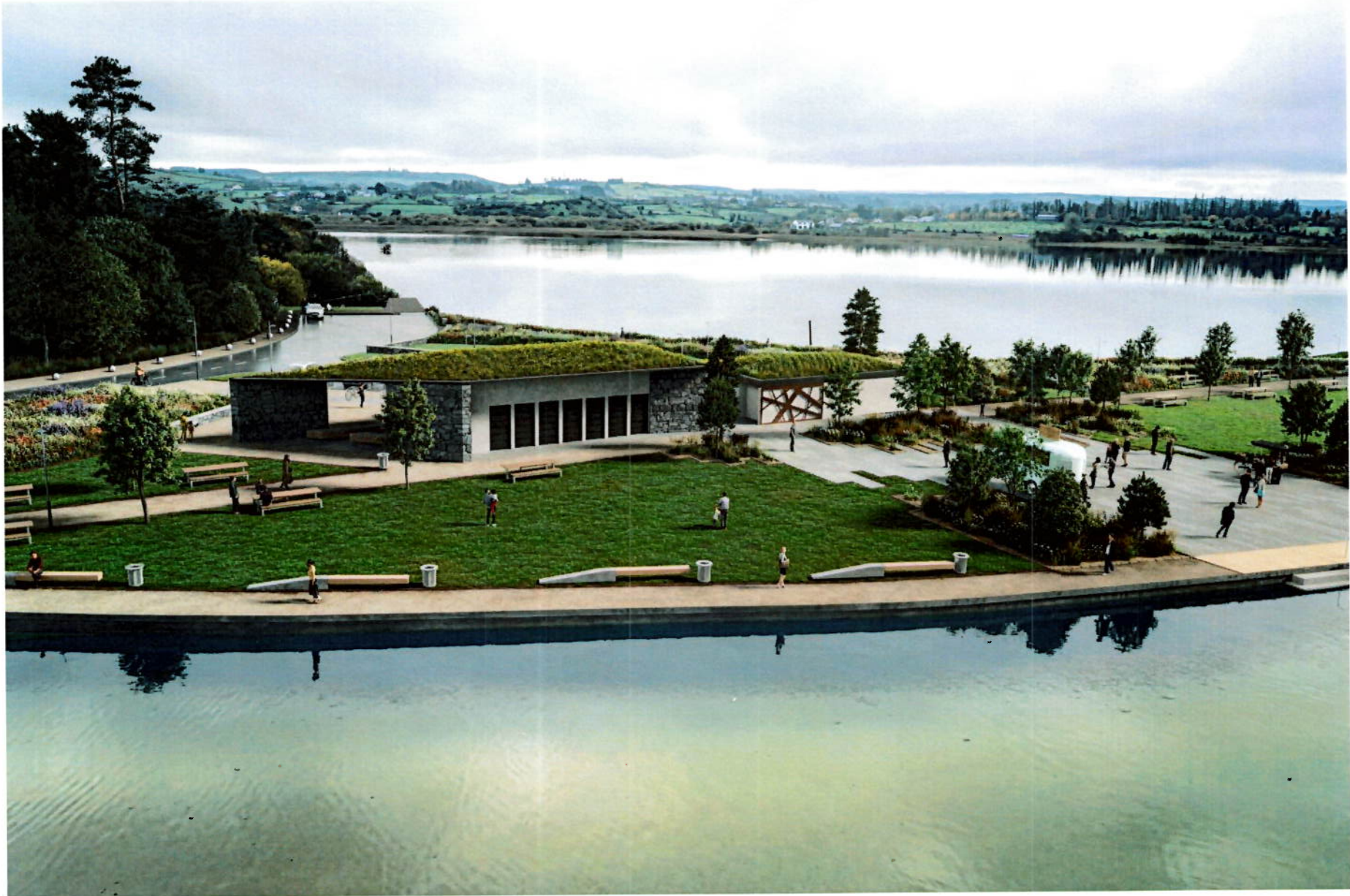

▲ 3d Render; Proposed Development



▲ 3d Render; Proposed Development



▲ 3d Render; Proposed Development